





series **260** for **AIR - WATER**  
closed and swivelling



Art. 89010

PATENTED

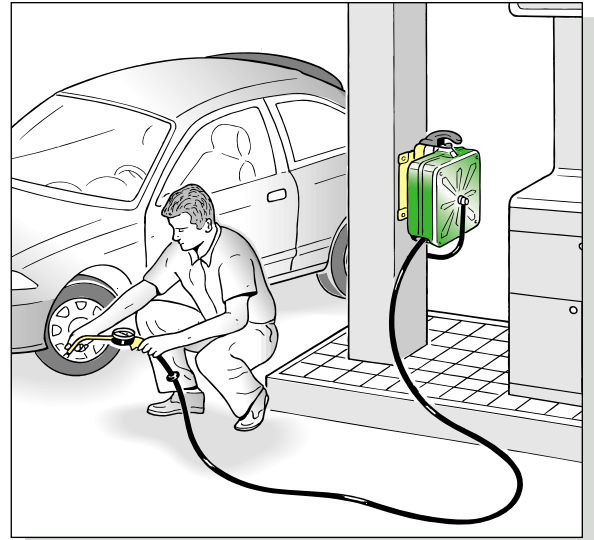

**Enclosed automatic hose-reel** for air and water with adjustable bayonet coupling bracket, indispensable for use with air-operated tools or delivery of water in all industries, workshops, service stations, garage, etc.

The hose-reel allows the desired length of hose to be extracted quickly and easily, for better work and functionality.

**Art. 89010 Hose-reel series 260 for air or water**  
Complete with bayonet coupling bracket (art.89001) and outlet swivel joint M 1/4" G

N° 1 packing  $m^3$  0,019 kg 6,5

**Art. 89001 Bayonet coupling wall bracket**  
already standard with hose-reels series 260

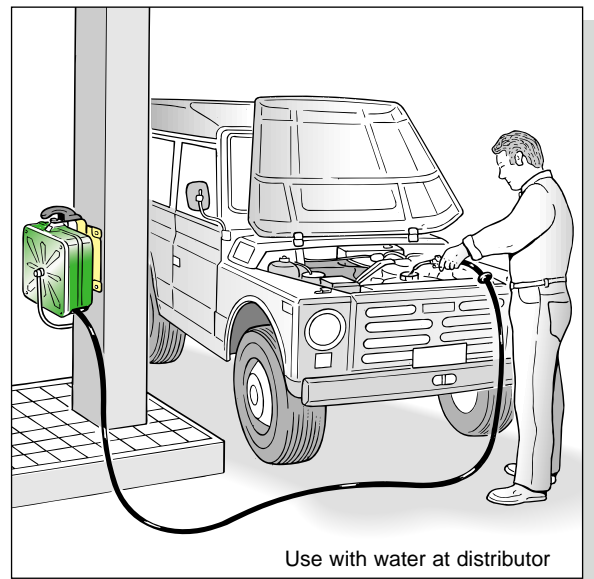
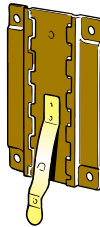

Use with water at distributor

Article	89010
Relative capacity	280 l/min
Hose	air-water 11 m
Connection hose	1,5 m
Diameter hose	ø8 x ø12 mm
Inlet and outlet connection	M 1/4" G
Max. working pressure	20 bar
Working temperature	-20° +60°C

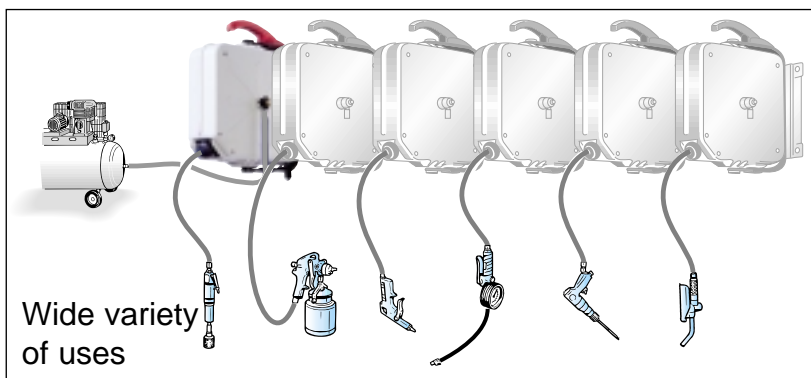

Wide variety of uses

### Overall dimensions

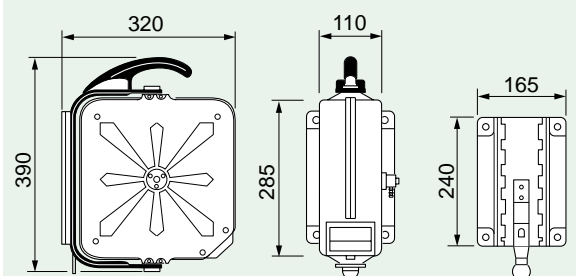

Wall-mounted

series 260 closed and swivelling

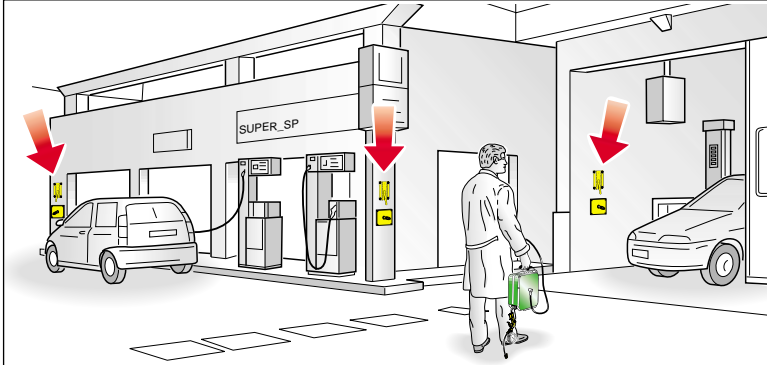

Every hose-reel is provided with a wall bracket (art. 89001) facilitating wall mounting. This bracket is equipped with bayonet hooking enabling quick connection and disconnection of hose-reel thus enabling it to be shifted to various workpoints, after applying more brackets.

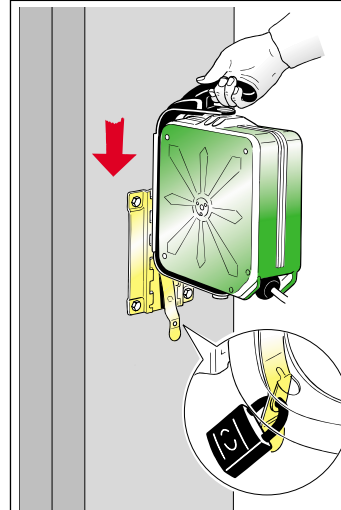

To prevent **removal or theft** of hose-reel it can be locked with a bolt or lock.

## QUICK HOOKING OF HOSE-REEL

Bayonet bracket art.89001  
easy wall-mounting

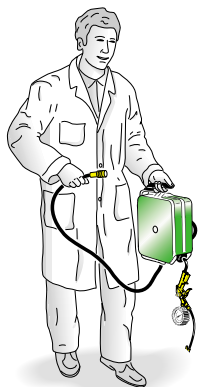

Easy to carry handle

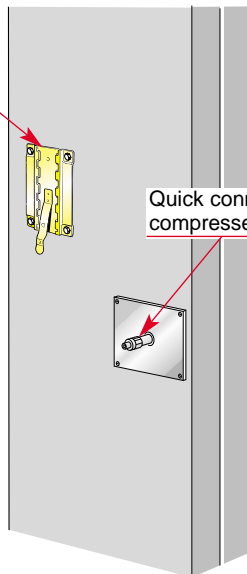

Quick connection to  
compressed-air system

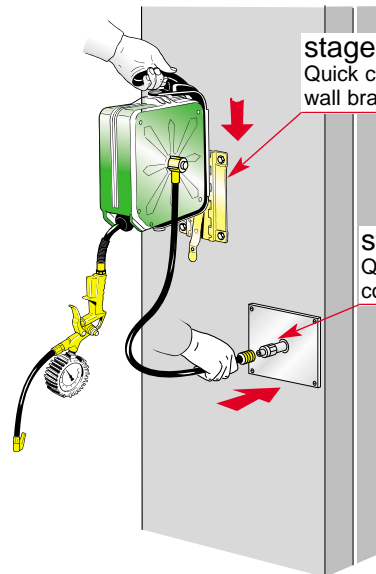

stage 1

Quick connection of hose-reel to  
wall bracket

stage 2

Quick connection to  
compressed-air system

## QUICK RELEASE OF HOSE-REEL

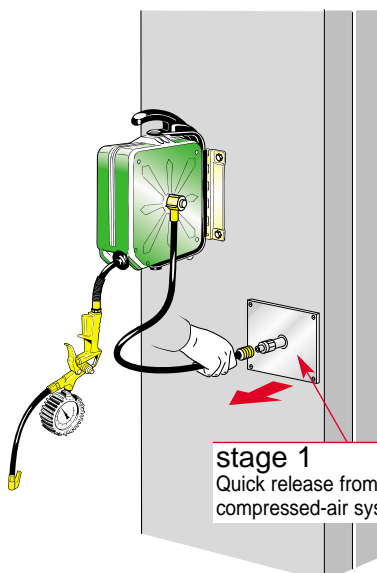

stage 1  
Quick release from  
compressed-air system

stage 2  
Quick release of  
hose-reel from wall  
bracket

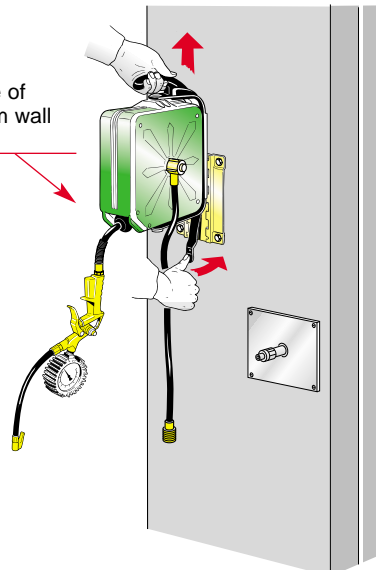

Easy to carry handle  
reduced weight



