

# A 926 Mobile



EN

## Professional 8-sensor wheel aligner for car and van, portable version.

- Sensor head with 2 high-resolution cameras, electronic inclinometer and level.
- Wireless data transmission through 2.4-GHz industrial radio devices, rechargeable commercial AA batteries with charger.
- Very compact and lightweight, it features oversize boom for large wheels.
- Low sensitivity to light noise makes it suitable for high ambient light environments.
- Sensor head features one-piece aluminium casting body for high precision!

# A 926 Mobile

Compatible with

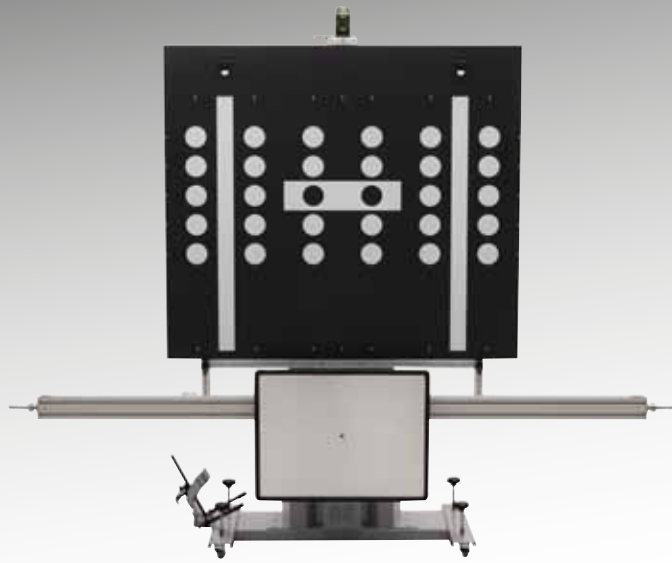

- The wheel aligner is compatible with the **new PROADAS universal system** used for the **calibration of driver assistance systems** on new generation vehicles.
- Using the wheel aligner sensors mounted on the PROADAS system, the system for calibrating the camera and radar on board **the vehicle can be aligned precisely and quickly.**
- Manufacturers recommend calibrating ADAS systems after aligning the vehicle. For more information **visit the PROADAS product section** on our website.

## Software



- Sice wheel alignment software: **SICE PRO Software.**
- Runout compensation may be push-pull or with lifted wheels, **database with over 40,000 vehicles**, setup screens with animated cursors and colour indications enable operator to work at a distance, printout with graphics.
- Live caster and kingpin inclination (KPI) measurement and adjustment
- Ready for operation with **Cal One-Touch®** (steering sensor calibration).

## Technical date

Total toe	± 20°
Half toe	± 10°
Camber	± 10°
Caster	± 30°
King pin	± 30°
Set back	± 10°
Thrust angle	± 8°
Dimensions (W x D x H)	<b>840x115x280 mm</b>

## Standard accessories



- Carrying case
- 4 radio sensor heads with batteries and charging system
- Radio module for central unit and hardlock
- DVD with truck and car software and Operating Instructions.

## Optional accessories

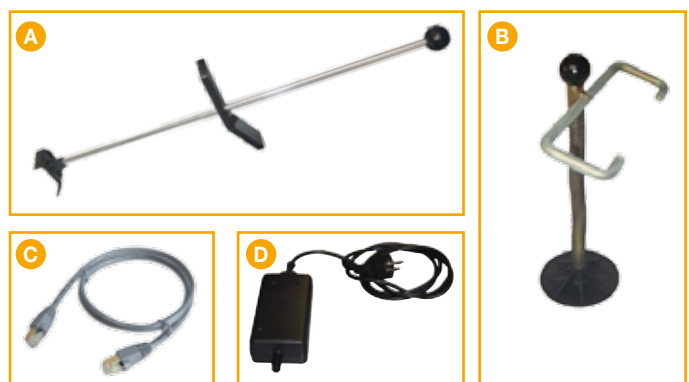

- Wheeled cabinet
- Wheel clamps with self-centring mounting system, quick-fit style
- Monitor, printer and mouse
- **A** Pedal depressor
- **B** Steering clamp
- **C** Emergency cables
- **D** Power supply unit to charge batteries with the PC off
- Laptop PC with multilingual Windows 10 IoT operating system

The manufacturer reserves the right to modify the features of its products at any time